

Van Nuys State Building

6150 VAN NUYS BLVD
VAN NUYS, CA 91401

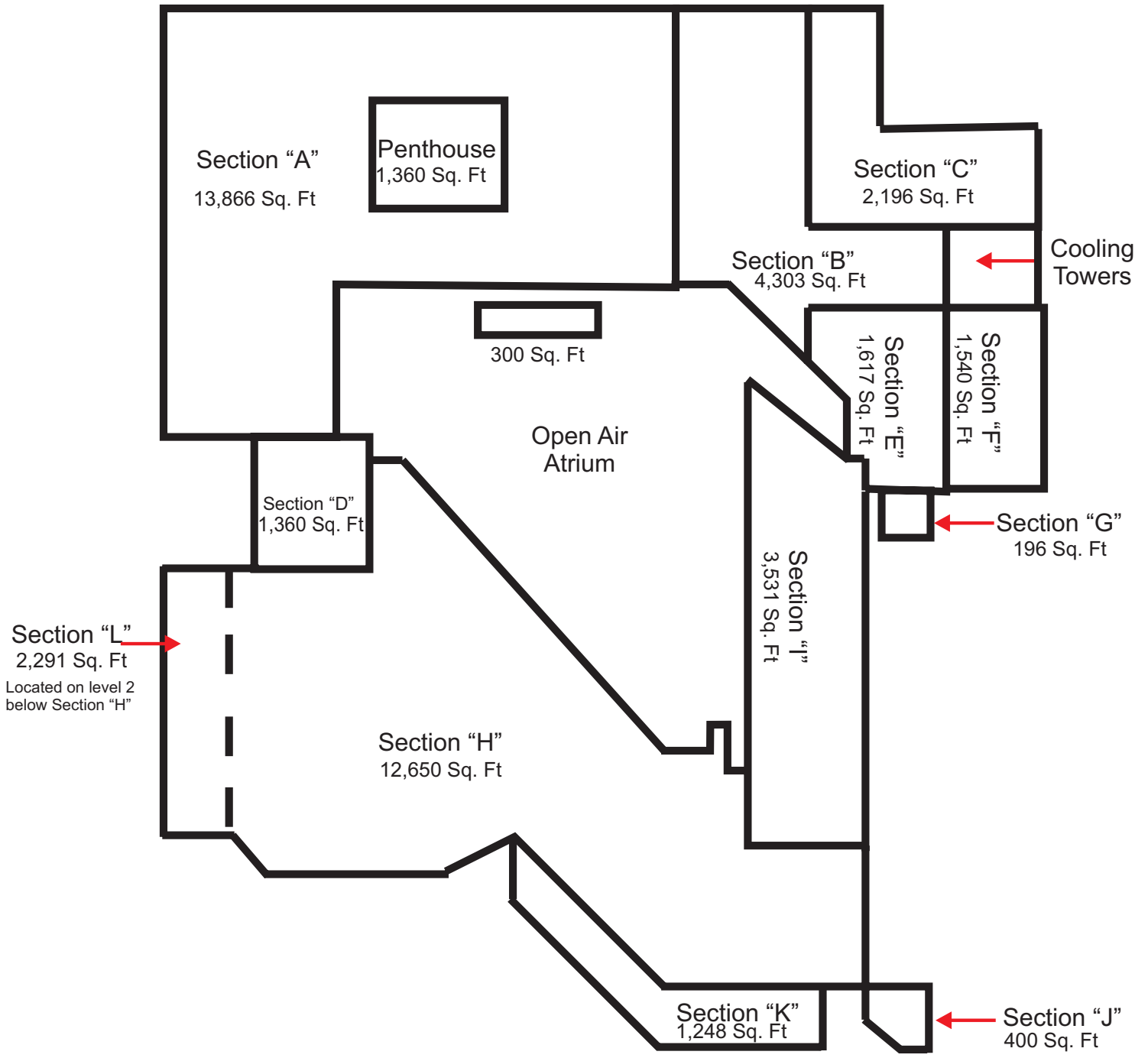



Set-up for this weekend was on the South-side of the structure. Great care was taken to ensure that the premises were kept and safe as clean as possible.



To ensure that no over-spray from the large volumes of emulsion used for this project to adjoining structures, masking paper was employed on walls and railings.



View of western wall of Section "I" showing masking paper covering parapet walls and pillars.



To ensure an uninterrupted flow of air to the A/C units, they were masked-off using polyester.



Flood lights were covered with polypropylene to protect them from over-spray.



After the first coat dried, these protective covers were removed revealing clean surfaces.



www.dgs.ca.gov

Van Nuys State Building

6150 VAN NUYS BLVD
VAN NUYS, CA 91401



Part of the crew employed spray hoses to ensure that any emulsion over-spray was quickly cleaned up.



View of the spray crew applying the first pass of the WeatherWeld seamless composite to Section "H".



Each pass of WeatherWeld has 8 lbs of multi-strand fiberglass roving and 15 gallons of UV stabilized emulsion.



Previously installed sections are seamlessly connected with no loss of strength to the completed composite membrane.



Fiberglass roving enters the applicator at over 30 miles per hour before being formed into an omni-directional reinforcement matrix.



The finished membrane has over 2.2 miles of fiberglass reinforcement per square foot. The finished composite membrane has over 350 lbs/in tensile strength and >10% elongation.



View of the first pass of WeatherWeld on Section "I".



View of Section "H" and the eyebrow Section "K" which were completed on their first application.



Completed Section "J" on the SE corner of structure.



Completed Section "D" overlooking lower Section "H".



Section "A" has been power washed in preparation for its application.



The metal counterflashings have been temporarily removed to apply the seamless composite up to the reglet above the baseflashings. These counterflashings will then be reattached.

Van Nuys State Building

6150 VAN NUYS BLVD
VAN NUYS, CA 91401



Van Nuys State Building

6150 VAN NUYS BLVD
VAN NUYS, CA 91401

